

Flooring Projects for Fayette County Public Schools (RFP 24-038-075)
Addendum 1

1. Site maps for locations with pending projects.
 - a. See attached site maps with project areas highlighted.

*Replace carpet with LVT in Front Office area

BUILDING YEAR	AREA (SQ. FT.)	I.U.'s Available
#2010	28,972	16
#2011	27,257	15
#2012	17,065	10
#2020	6,400	1
TOTAL	79,694	42

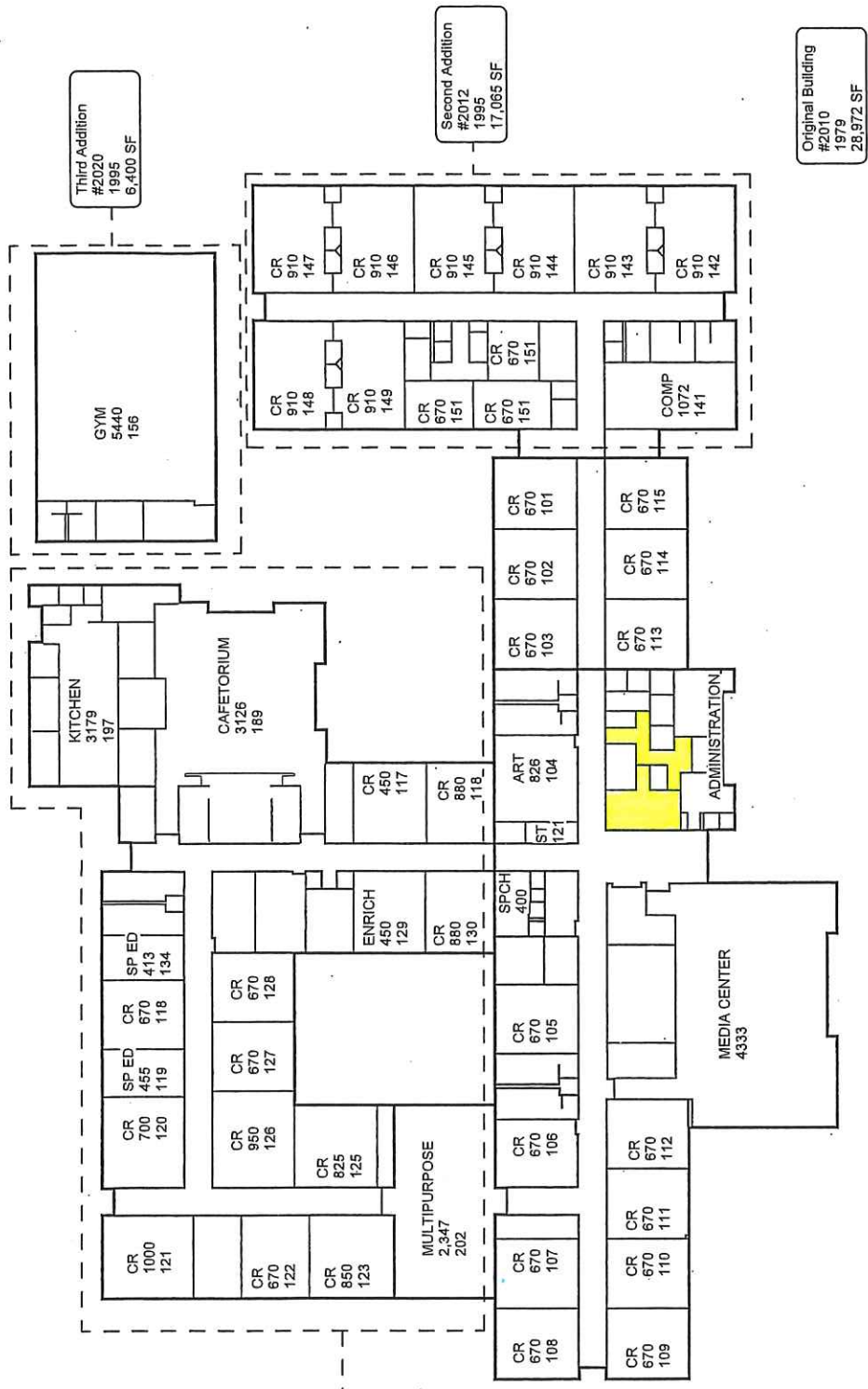

First Addition
#2011
1980
27,257 SF

Second Addition
#2012
1995
17,065 SF

Third Addition
#2020
1995
6,400 SF

Original Building
#2010
1979
28,972 SF

HUDDLESTON ELEMENTARY SCHOOL

ACREAGE: 11.2 ACRES

FACILITY NO.: 0180

Fayette County Board of Education

*Remove carpet and replace with carpet squares in admin offices and conference room. Install LVT in front office and hallways

BUILDING YEAR	AREA (SQ. FT.)	I.U.'s Available
#2010	86,172	43
TOTAL	86,172	43

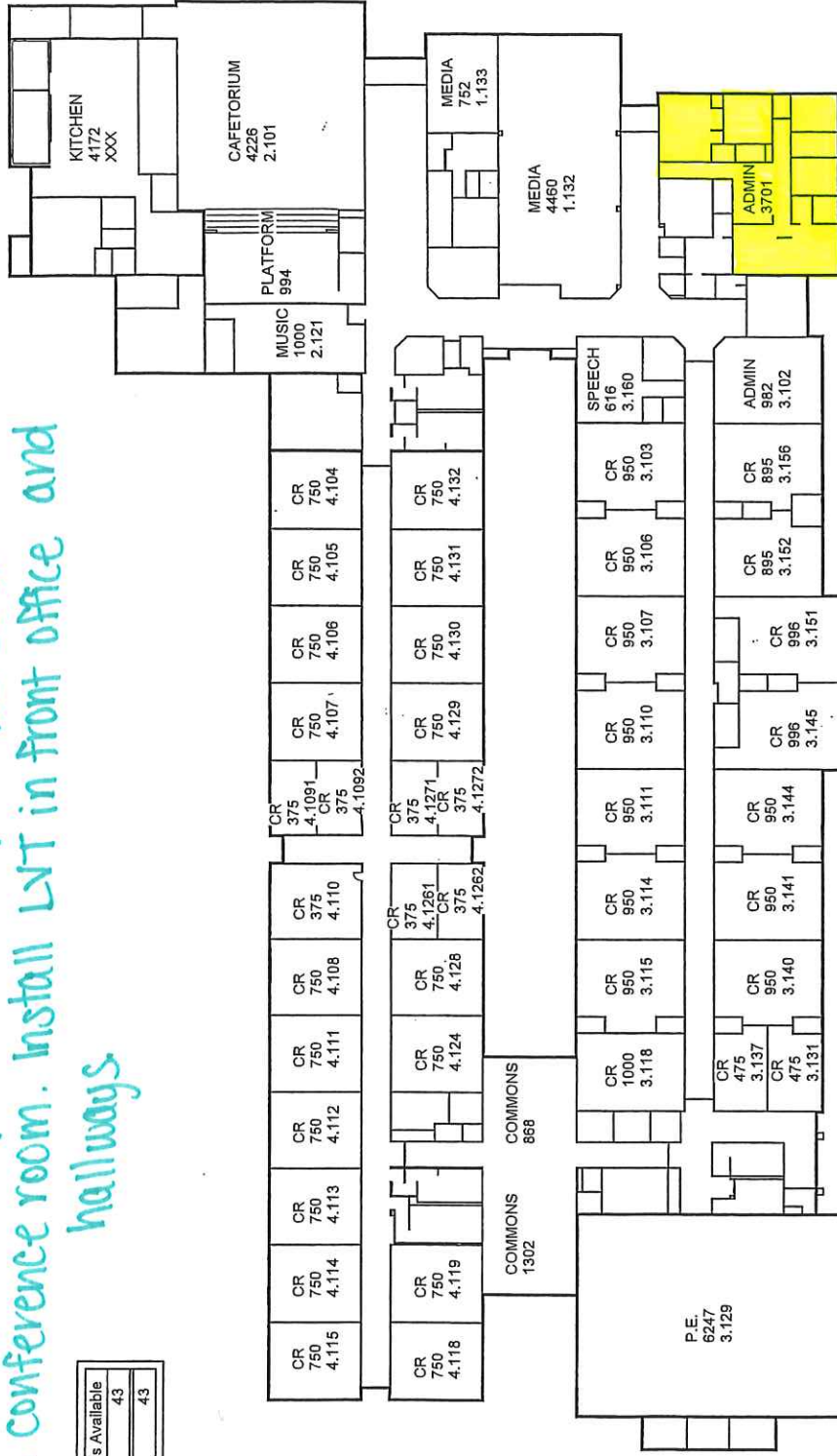

Original Building
#2010
2009
86,172 SF

INMAN ELEMENTARY SCHOOL

ACREAGE: 20 ACRES +/-

FACILITY NO.: 0109

Fayette County Board of Education

* Replace carpet with carpet squares in music room

BUILDING YEAR	AREA (SQ. FT.)	I.U.'s Available
#2010	87,734	46
TOTAL	87,734	46

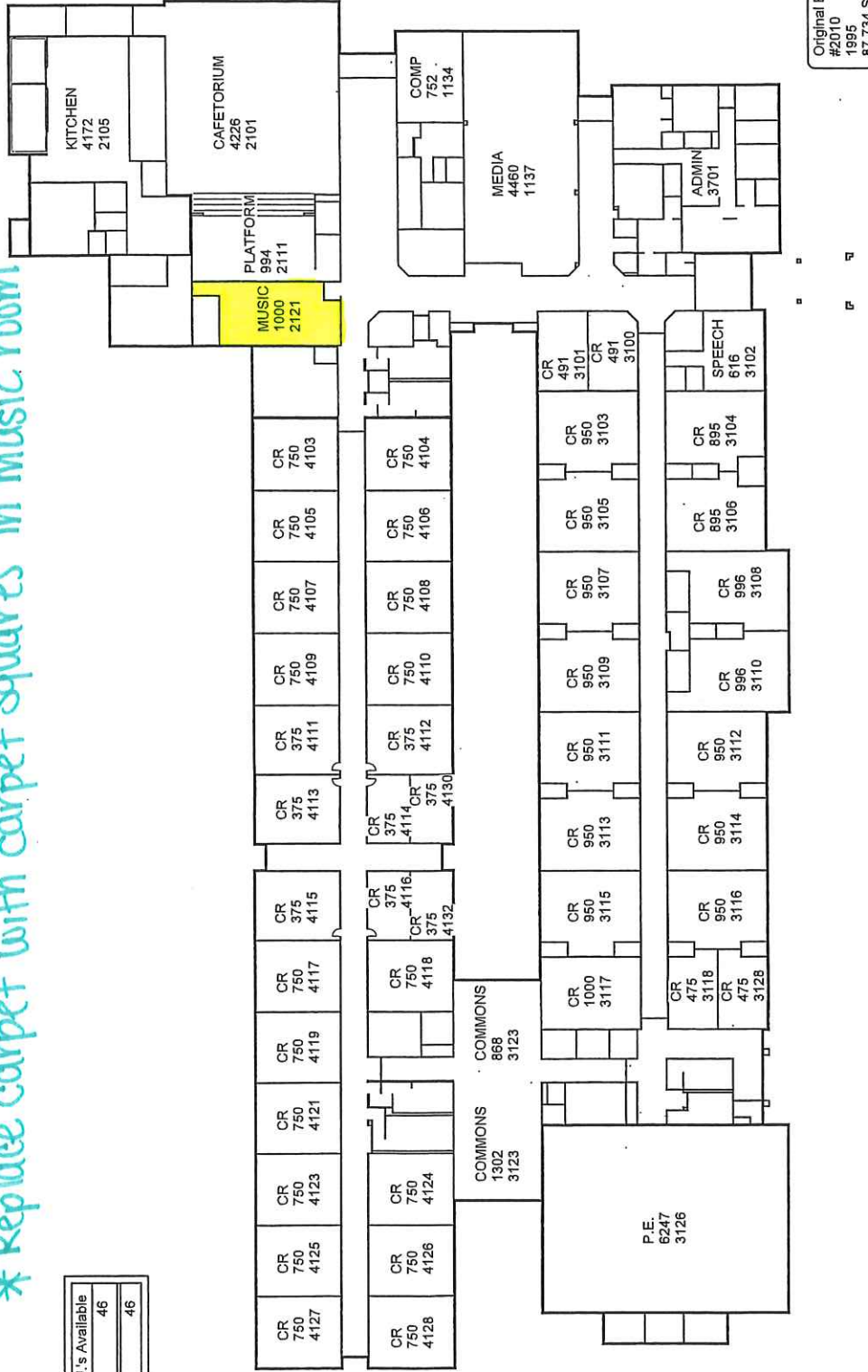

KEDRON ELEMENTARY SCHOOL

ACREAGE: 19.49 ACRES

FACILITY NO.: 0196

Fayette County Board of Education

*Replace carpet with LVT in the front office and hallways.

BUILDING	YEAR	AREA (SQ. FT.)	I.U.'s Available
#2010	1998	87,734	46
#2011	2007	6,864	6
TOTAL		94,598	52

First Addition
#2011
2007
6,864 SF

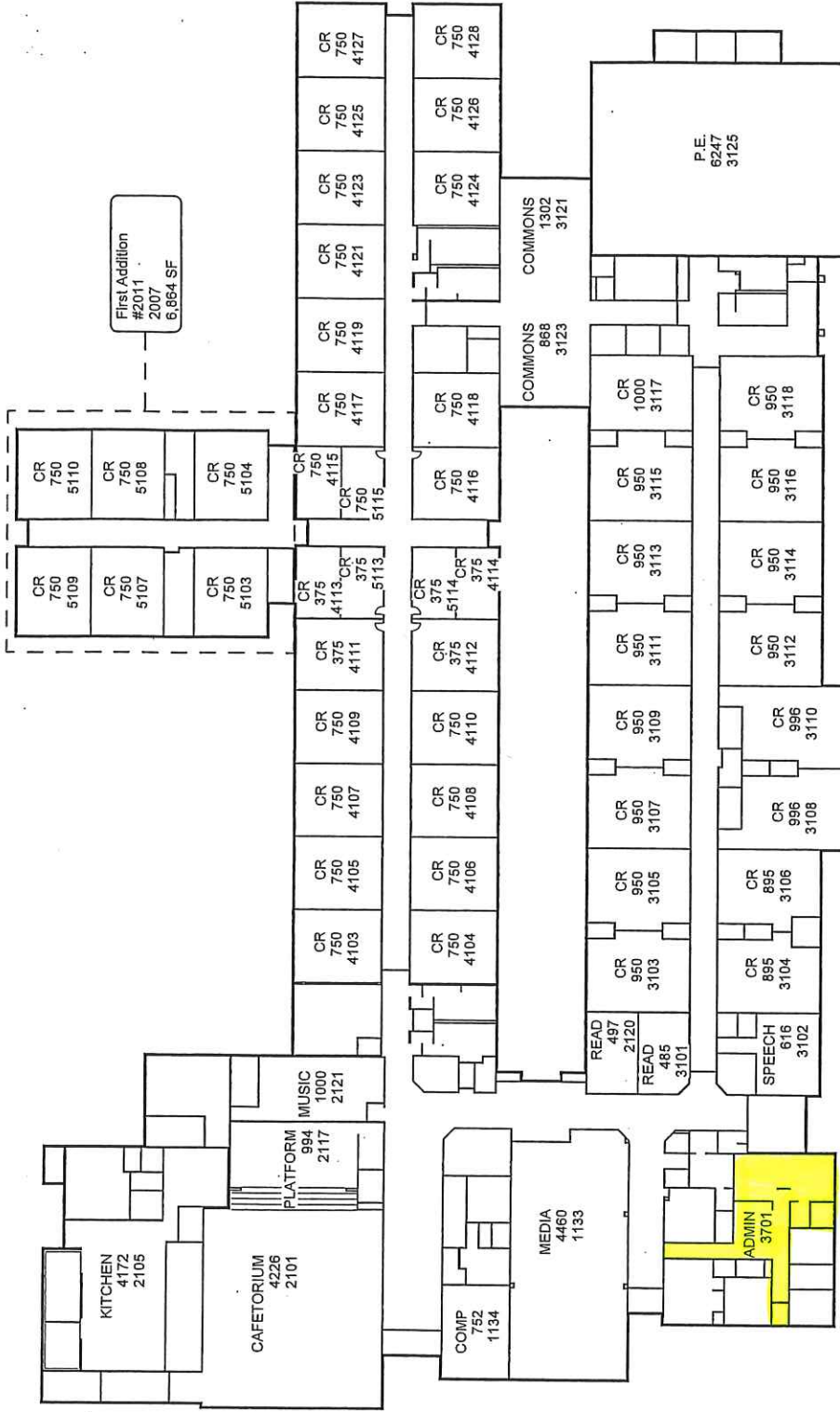

Original Building
#2010
1998
87,734 SF

PEEPLER'S ELEMENTARY SCHOOL

ACREAGE: 20 ACRES +/-

FACILITY NO.: 0199

Fayette County Board of Education